

ZONING LEGEND

- (R-1) ESTATE-TYPE RESIDENTIAL DISTRICT
- (R-2) LOW DENSITY RESIDENTIAL DISTRICT (SINGLE FAMILY)
- (R-3) MEDIUM DENSITY RESIDENTIAL DISTRICT (SINGLE & MULTI-FAMILY)
- (HBD) HIGHWAY BUSINESS DISTRICT
- (LBD) LOCAL BUSINESS DISTRICT
- (CBD) CENTRAL BUSINESS DISTRICT
- (UVD) URBAN VILLAGE DISTRICT
- (M-1) LIGHT MANUFACTURING DISTRICT
- (M-2) HEAVY MANUFACTURING DISTRICT
- (ED) EMPLOYMENT CENTER DISTRICT
- (PUD) PLANNED UNIT DEVELOPMENT DISTRICT
- (PUD-MU) PLANNED UNIT DEVELOPMENT-MIXED USE
- (PUD-O) PLANNED UNIT DEVELOPMENT-OFFICE
- (PUD-B) PLANNED UNIT DEVELOPMENT-BUSINESS
- (PUD-R) PLANNED UNIT DEVELOPMENT-RESIDENTIAL
- (O-R) OFFICE-RESIDENTIAL DISTRICT
- (O) OFFICE PARK DISTRICT
- (ADD-1) AUSTIN DEVELOPMENT DISTRICT 1
- (ADD-2) AUSTIN DEVELOPMENT DISTRICT 2

OFFICIAL ZONING MAP

CITY OF SPRINGBORO

WARREN/MONTGOMERY COUNTY, OHIO

REVISIONS	
MONTH	YEAR
MAY 15	2014
FEBRUARY 19	2015
SEPTEMBER 15	2016
JANUARY 5	2017
FEBRUARY 16	2017
JANUARY 4	2018
JANUARY 2	2020
MARCH 3	2022
OCTOBER 20	2022

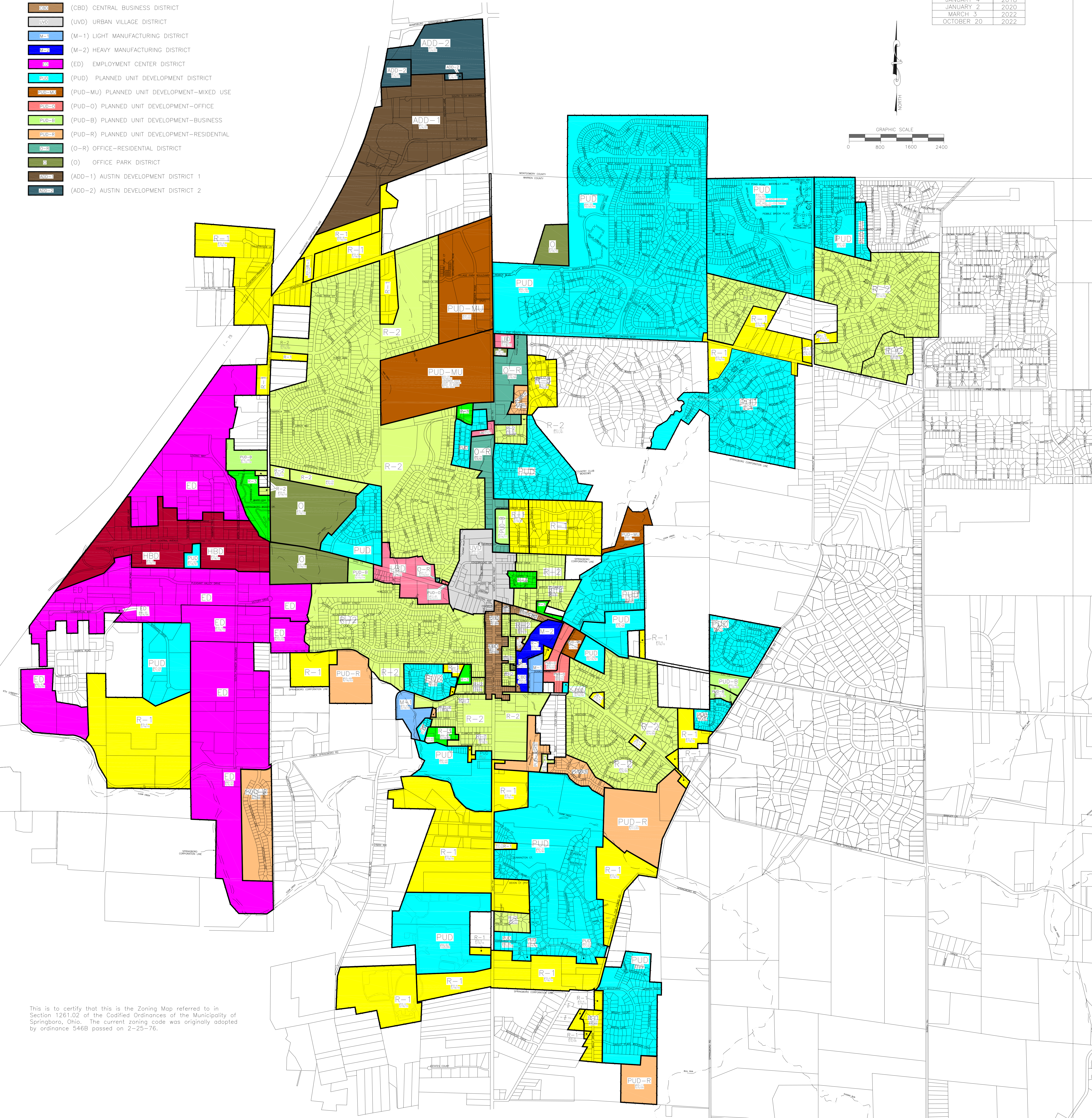
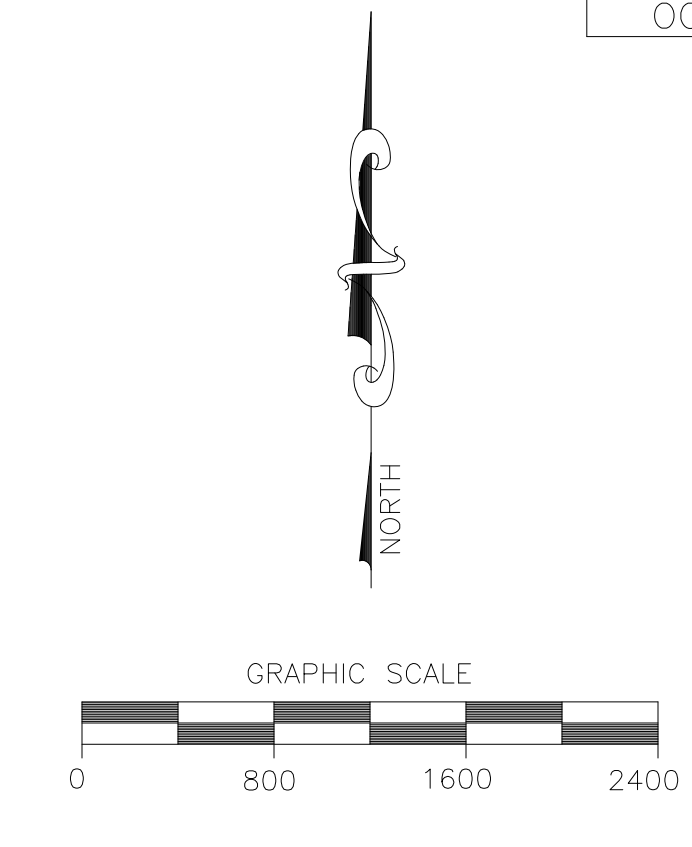

This is to certify that this is the Zoning Map referred to in Section 1261.02 of the Codified Ordinances of the Municipality of Springboro, Ohio. The current zoning code was originally adopted by ordinance 546B passed on 2-25-76.